

sukunfuku studio was founded in Rotterdam in 2008 by Miguel Huelga and Iria de la Peña. Their work integrates research, architecture, urbanism, landscape and graphic design.

Miguel Huelga studied architecture at the High Technical School in Valladolid, where he received his Diploma with Honours in 2007, and did a Master of Parametric Design and Digital Architecture at the Pompeu i Fabra University in Barcelona (2009-10). He has worked in several practices like, Office for Metropolitan Architecture - Rem Koolhaas in Rotterdam (2007-09), Kengo Kuma and Associates in Tokyo and Paris (2010-2014), David Chipperfield Architects (2014-2015) and Duggan Morris Architects in London (2015-2016).

Iria de la Peña studied at the High Technical School in Madrid where she graduated with Distinction in 2008, and did a Master of Parametric Design and Digital Architecture at the Pompeu i Fabra University in Barcelona (2009-10). Following working in Madrid she worked for Erick van Egeraat and Associates in Rotterdam (2008), Office for Metropolitan Architecture - Rem Koolhaas in Rotterdam (2009), Akihisa Hirata Office in Tokyo (2010-2012) and ACME in London (2012-2016).

Project Experience

* Summer Residence Refurbishment in Salinas
Client: AJCEUO / Oviedo University (SP)
Residence and cultural building renovation and extension

* Neruca House
Client: Private (SP)
Single - family home

* Puente Viesgo Rock Art Visitors Centre
Client: Government of Cantabria (SP)
Visitors and interpretation centre

* Sluisbuurt Primary School Complex
Client: Amsterdam Municipality (NL)
Feasibility study

* Sluisbuurt Master Plan
Client: Amsterdam Municipality (NL)
Urban planning

* Ylivieskan Church
Client: Parish of Ylivieska (FI)
Church

* Voynich café
Client: Museo del libro (ES)
Interior design

* Enxendra Office refurbishment
Client: Enxendra Technologies (ES)
Office refurbishment

* Lasita Maja pre-fab system competition
Client: Katus.eu + Lasita Maja AS (SI)
Prefabrication system

* Archtriumph pavilion 2015 at V&A museum of childhood gardens
Client: Archtriumph (UK)
Sky pavilion

* Sea town extension in Simrishamn
Client: Municipality of Simrishamn (SE)
Housing: A new residential development and maritime promenade

* SHIFT Boston
Client: City of Boston (US)
Cultural: Public space, Film Festival, Waterfront, Special events

Competition 1st prize
Area: 1590m2
In progress

Commission
Area: 214m2
In progress

Competition 1st prize
Area: 1765m2
In progress

Commission
Area: 4765m2

Competition 1st prize
Area: 2.29 Ha

Competition
Area: 1800 m2

Commission
Area: 35.6 m2

Commission
Area: 91.13 m2

Competition Special Mention
Area: 6-60 m2

Competition 2nd prize
Area: 38.8 m2

Competition 1st prize
Area: 70.000 m2

Competition Shortlisted
Area: 1.000 m2

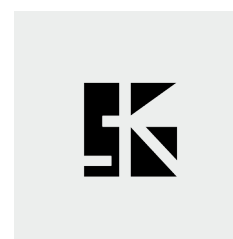

sukunfuku • studio
Conde Guadalhorce 2
Entrl - A. 33206. Gijón
T (+34) 985 874 571
info@sukunfuku.com
www.sukunfuku.com

Honours + Awards

Summer Residence in Salinas (SP)
First Prize. 2019

Puente Viesgo Rock Art Visitors Centre (SP)
First Prize. 2018

Sluisbuurt Master Plan (NL) E14
First Prize. 2017

Lasita Maja pre-fab system (ES)
Special mention. 2017

Aylesbury Health Centre (UK) with DMA
1st Prize. 2015

Archtriumph pavilion. V&A Childhood Museum (UK)
2nd Prize. 2015

MosFilm Site Moscow (RU) with DCA
2nd Prize. 2014

Congress Centre Angers (FR) with KKAA
1st Prize. 2014

M.H.B. Montpellier (FR) with KKAA
3rd Prize. 2014

Kyoto Prefecture Library (JP) with HAO
2nd Prize. 2012

Sea town extension. Simrishamn (SW) E11
First Prize. 2011

Kaohsiung Pop Music Centre (TW) with HAO
2nd Prize. 2011

Anterselva Fire Station (IT) with KKAA
Honourable Mention. 2011

SHIFT Boston Ideas Competition (USA)
Shortlisted. 2009

Art Centre Taipei (TW) with OMA
1st Prize. 2009

Budapest cityhall (HU) with EEA
1st Prize. 2009



Relevant projects in collaboration with other offices

* Aylesbury Health Centre + Nursery. London (UK)
Office: Duggan Morris Architects
Services: Health Centre + Nursery

* Greenwich Peninsula Plot 18.03/ 235. London (UK)
Office: Duggan Morris Architects
Housing Residential Units

* Selfridges Renovation. London (UK)
Office: David Chipperfield Architects
Retail: Building renovation and extension

* Portland House. London (UK)
Office: David Chipperfield Architects
Housing Development

* Angers Congress Centre (FR)
Office: Kengo Kuma and Associates
Cultural: Congress Center, Philharmonic, Hotel

* Haydon Gardens Apartments. London (UK)
Office: ACME
High end residential apartments

* Aldgate Canopy hotel. London (UK)
Office: ACME
Hotel and Restaurant

* Ordrupgaard Fine Arts Museum Extension (DK)
Office: Kengo Kuma and Associates
Fine Arts Museum: Impressionist collection

* Helsinki Central Library (FI)
Office: Kengo Kuma and Associates
Cultural: Library

* National History Museum in Copenhagen (DK)
Office: Kengo Kuma and Associates
Cultural: Museum Extension

* MCBA Fine Arts Museum in Lausanne (SW)
Office: Kengo Kuma and Associates
Cultural: Fine Arts Museum

* Tree Ness House Project (JP)
Office: Akihisa Hirata Architecture Office
Housing: Residence, Art gallery

* Cordoba Congress Centre (ES)
Office: Office for Metropolitan Architecture
Cultural: Congress Centre & Orchestra

* Prada Transformer, Seoul (SKO)
Office: Office for Metropolitan Architecture
Cultural: Fashion Show, Cinema, Exhibition space

* Taipei Performing Arts Center (TW)
Office: Office for Metropolitan Architecture
Cultural: Performing Arts Centre

* Budapest City Hall (HU)
Office: Erick Van Egeraat and Associates
Office: City Hall extension

* Housing, Retail, Offices in Zaragoza (ES)
Office: Casanova+Hernández Arkitekten
Housing: Hybrid development

Commission
RIBA Stages 1-2
Area: 4.500 m2

Commission
RIBA Stages 1-3+
Area: 25.000 m2

Commission
Completed
Area: 5.000 m2

Commission
RIBA Stage 4
Area: 28.000 m2

Competition 1st prize
Cancelled
Area: 25.000 m2

Commission
RIBA Stage 1-4
Area: 8.500 m2

Commission
RIBA Stage 2
Area: 16.400 m2 (373 keys)

Shortlisted Competition
Finalist
Area: 2.000 m2

Competition
-
Area: 10.000 m2

Shortlisted Competition
Finalist
Area: 15.000 m2

Shortlisted Competition
Finalist
Area: 4.500 m2

Commission
Design Development
Area: 450 m2

Competition 1st prize
Final DD submission
Area: 26.966 m2

Commission
Concept design / Completed
Area: 400 m2

Competition 1st prize
Construction
Area: 40.000 m2

Competition 1st prize
-
Area: 98.363 m2

Competition 3rd prize
-
Area: 40.000 m2

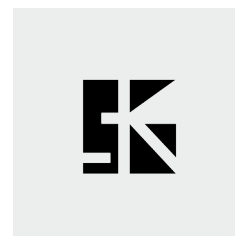

sukunfuku • studio
Conde Guadalhorce 2
Entri - A. 33206. Gijón
T (+34) 985 874 571
info@sukunfuku.com
www.sukunfuku.com

Collaborators addresses

DCA-David Chipperfield Architects Ltd
11 York Road London
SE17NX, United Kingdom T +44 20 7620 4800

DMA-Duggan Morris Architects
Unit 7. 16-24 Underwood Street London
N17JQ T United Kingdom T +44(0) 20 7566 7440

KAE- Kuma & Associates Europe
16 Rue Martel, Paris
75010 France T +33 (0)1 44 88 94 90

ACME
2-6 New North Place London
EC2A 4JA United Kingdom T +44 20 7998 6319

KKAA-Kengo Kuma & Associates
2-24-8 Minami Aoyama, Minato-Ku Tokyo
107.0062 Japan T +81 3 3401 7721

AHO-Akihisa Hirata Office
2F 6-6-22 minamiaoyama minatoku Tokyo
107-0062 Japan T +81-(0)3-3409-145

OMA-Office for Metropolitan Architecture
Heer Bokelweg 149 Rotterdam
AD 3032 Netherlands T +31 10 243 82 00

EEA-Erick van Egeraat & Associates
Calandstraat 23 Rotterdam
3016 CA Netherlands T +31 10 436 96 86

CHA-Casanova & Hernandez Architekten
Pannekoekstraat 104 Rotterdam
3011 LL Netherlands T +31 10 240 93 33



sukunfuku studio fue fundado en Rotterdam en 2008 por Miguel Huelga e Iria de la Peña. El trabajo de la oficina integra investigación, arquitectura, urbanismo, paisajismo y diseño gráfico.

Miguel Huelga estudió arquitectura en la Escuela Técnica Superior de Arquitectura de Valladolid, donde recibió su Diploma con Honores en 2007. Desde entonces ha trabajado en oficinas como Office for Metropolitan Architecture - Rem Koolhaas en Rotterdam (2007-09), Kengo Kuma and Associates en Tokio y París (2010-2014), David Chipperfield Architects (2014-2015) y Duggan Morris Architects en Londres (2015- 2016). Entre 2009 y 2010 completó un Master en 'Diseño Avanzado y Arquitectura Digital' en la Universidad Pompeu i Fabra de Barcelona.

Iria de la Peña cursó sus estudios en la Escuela Técnica Superior de Arquitectura de Madrid donde se graduó con distinciones en 2008. Tras trabajar inicialmente en Madrid pasó a colaborar con oficinas como Erick van Egeraat and Associates en Rotterdam (2008), Office for Metropolitan Architecture - Rem Koolhaas en Rotterdam (2009), Akihisa Hirata Office en Tokio (2010-2012) y ACME en Londres (2012-2016). Entre 2009 y 2010 completó un Master en 'Diseño Avanzado y Arquitectura Digital' en la Universidad Pompeu i Fabra de Barcelona.

Proyectos Realizados

* Rehabilitación de la finca y residencia de las Colonias Escolares de Salinas
 Cliente: AJCEUO / Universidad de Oviedo (SP)
 Rehabilitación y ampliación de alojamiento y edificio dotacional

* Casa Neruca
 Cliente: Privado (SP)
 Vivienda unifamiliar

* Centro del Arte Rupestre en Puente Viesgo
 Cliente: Gobierno de Cantabria (SP)
 Centro de Interpretación

* Escuela y edificio multiusos en Sluisbuurt
 Cliente: Ayuntamiento de Amsterdam (NL)
 Estudio de viabilidad

* Sluisbuurt Master Plan
 Cliente: Ayuntamiento de Amsterdam (NL)
 Planeamiento urbano

* Ylivieskan Church
 Cliente: Iglesia parroquial de Ylivieska (FI)
 Iglesia parroquial

* Voynich café
 Cliente: Museo del libro (ES)
 Proyecto de interiorismo

* Proyecto de reforma de oficinas
 Cliente: Enxendra Technologies (ES)
 Reforma de oficina

* Concurso de sistemas prefabricados Lasita maja
 Cliente: Katus.eu + Lasita Maja AS (SI)
 Sistema de prefabricación

* Pabellón Archtriumph 2015. Jardines del V&A, Museo de la infancia
 Cliente: Archtriumph (UK)
 Pabellón temporal

* Extensión del frente marítimo de Simrishamn
 Cliente: Ayuntamiento de Simrishamn (SE)
 Residencial : Nuevo desarrollo residencial y paseo marítimo

* SHIFT Boston
 Cliente: Ciudad de Boston (US)
 Cultural: Espacio público, paseo marítimo, zona de eventos.

Concurso. 1er premio
 Área: 1590m2
 En construcción

Encargo
 Área: 214m2
 En construcción

Concurso. 1er premio
 Área: 1765m2
 En construcción

Encargo
 Área: 4765m2

Concurso. 1er premio
 Área: 2.29 Ha

Concurso
 Área: 1800 m2

Encargo
 Área: 35.6 m2

Encargo
 Área: 91.13 m2

Concurso. Mención especial
 Área: 6-60 m2

Concurso, 2o premio
 Área: 38.8 m2

Concurso. 1er premio
 Área: 70.000 m2

Concurso. Seleccionado
 Área: 1.000 m2

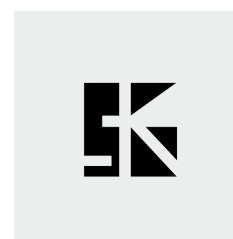

sukunfuku • studio
 Conde Guadalhorce 2
 Entrl - A. 33206. Gijón
 T (+34) 985 874 571
 info@sukunfuku.com
 www.sukunfuku.com

Premios + Distinciones

Colonias Escolares en Salinas (SP)
 Primer premio. 2019

Centro de Arte Rupestre en Puente Viesgo (SP)
 Primer premio. 2018

Sluisbuurt Master Plan (NL)
 Primer premio European 14. 2017

Concurso de sistemas prefabricados (SI)
 Mención especial. 2017

Centro de salud y guardería en Aylesbury (UK)
 Primer premio. 2015 con DMA

Pabellón Archtriumph. Jardines del V&A (UK)
 Segundo premio. 2015

MosFilm Masterplan. Moscu (RU) con DCA
 Segundo premio. 2014

Centro de Congresos de Angers (FR) con KKAA
 Primer premio. 2014

M.H.B. Montpellier (FR) con KKAA
 Tercer premio. 2014

Biblioteca prefectura de Kyoto (JP) con HAO
 Segundo premio. 2012

Frente marítimo y viviendas en Simrishamn (SW)
 Primer premio. 2011

Kaohsiung Pop Music Center (TW) con HAO
 Segundo premio. 2011

Estación de bomberos, Anterselva (IT) con KKAA
 Mención. 2011

Concurso de ideas SHIFT Boston (USA)
 Seleccionado. 2009

Taipei Performing Arts Center (TW) con OMA
 Primer premio. 2009

Ayuntamiento de Budapest (HU) con EEA
 Primer premio. 2009

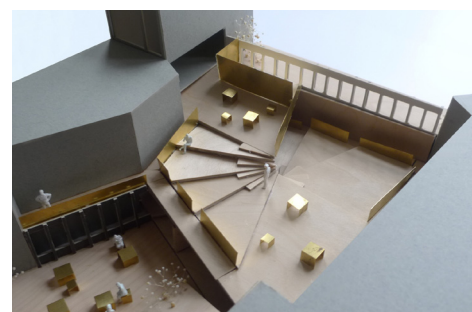

Proyectos relevantes con otras oficinas

* Centro de salud y guardería en Aylesbury. Londres (UK)

Oficina: Duggan Morris Architects
Servicios: Centro de salud y Guardería

* Greenwich Peninsula Plot 18.03/ 235 . Londres (UK)

Oficina: Duggan Morris Architects
Residencial

* Renovacion de Selfridges. Londres (UK)

Oficina: David Chipperfield Architects
Comercial: Renovación y extensión

* Portland House. Londres (UK)

Oficina: David Chipperfield Architects
Residencial

* Centro de Congresos en Angers (FR)

Oficina: Kengo Kuma and Associates
Cultural: Centro de Congresos, Filarmónica, Hotel

*Apartamentos Haydon Gardens. Londres (UK)

Oficina: ACME
Torre de Apartamentos

*Aldgate Canopy hotel. Londres (UK)

Oficina: ACME
Hotel y Restaurante

* Ordrupgaard Fine Arts Museum Extension (DN)

Oficina: Kengo Kuma and Associates
Museo de Bellas Artes: Colección impresionista

* Helsinki Central Library (FN)

Oficina: Kengo Kuma and Associates
Cultural: Biblioteca

* National History Museum in Copenhagen (DN)

Oficina: Kengo Kuma and Associates
Cultural: Museo de Historia Natural. Extensión

* MCBA Fine Arts Museum in Lausanne (SW)

Oficina: Kengo Kuma and Associates
Cultural: Museo de Bellas Artes

* Tree Ness House Project (JP)

Oficina: Akihisa Hirata Architecture Office
Residencial: Vivienda y Galería de Arte

* Cordoba Congress Centre (SP)

Oficina: Office for Metropolitan Architecture
Cultural: Centro de Congresos y orquesta

* Prada Transformer, Seoul (KO)

Oficina: Office for Metropolitan Architecture
Cultural: Fashion Show, Cine, Espacio de exhibición

* Taipei Performing Arts Center (TW)

Oficina: Office for Metropolitan Architecture
Cultural: Centro de artes escénicas

* Budapest City Hall (HU)

Oficina: Erick Van Egeraat and Associates
Office: Extensión de ayuntamiento

* Housing, Retail, Offices in Zaragoza (SP)

Oficina: Casanova+Hernández Arkitekten
Residencial: desarrollo híbrido

Encargo
RIBA fases 1-2
Área: 4.500 m2

Encargo
RIBA fases 1-3+
Área: 25.000 m2

Encargo
Completado
Área: 5.000 m2

Encargo
RIBA Fase 4
Área: 28.000 m2

Concurso. 1er premio
Cancelado
Área: 25.000 m2

Encargo
RIBA Fases 1-4
Área: 8.500 m2

Encargo
RIBA Fase 2
Área: 16.400 m2 (373 llaves)

Concurso por invitación
Finalista
Área: 2.000 m2

Concurso
Concepto
Área: 10.000 m2

Concurso por invitación
Finalista
Área: 15.000 m2

Concurso por invitación
Finalista
Área: 4.500 m2

Encargo
En construcción
Área: 450 m2

Concurso. 1er premio
Proyecto de ejecución
Área: 26.966 m2

Encargo
Completado
Área: 400 m2

Concurso. 1er premio
En construcción
Área: 40.000 m2

Concurso. 1er premio
Cancelado
Área: 98.363 m2

Concurso. 3er premio
Concepto
Área: 40.000 m2

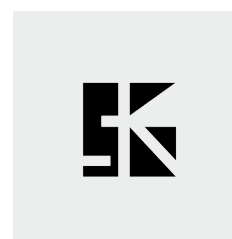

sukunfuku • studio

Conde Guadalhorce 2
Entri - A. 33206. Gijón
T (+34) 985 874 571
info@sukunfuku.com
www.sukunfuku.com

Direcciones de colaboradores

DCA-David Chipperfield Architects Ltd
11 York Road London
SE17NX, United Kingdom T +44 20 7620 4800

DMA-Duggan Morris Architects
Unit 7. 16-24 Underwood Street London
N17JQ T United Kingdom T +44(0) 20 7566 7440

KAE-Kuma & Associates Europe
16, rue Martel, Paris
75010 France T +33 (0)1 44 88 94 90

ACME
2-6 New North Place London
EC2A 4JA UK T +44 20 7998 6319

AHO-Akihisa Hirata Office
2F 6-6-22 minamiaoyama minatoku Tokyo
107-0062 Japan T +81-(0)3-3409-145

KKAA-Kengo Kuma & Associates
2-24-8 Minami Aoyama, Minato-Ku Tokyo
107.0062 Japan T +81 3 3401 7721

OMA-Office for Metropolitan Architecture
Heer Bokelweg 149 Rotterdam
AD 3032 Netherlands T +31 10 243 82 00

EEA-Erick van Egeraat & Associates
Calandstraat 23 Rotterdam
3016 CA Netherlands T +31 10 436 96 86

CHA-Casanova & Hernandez Architekten
Pannekoekstraat 104 Rotterdam
3011 LL Netherlands T +31 10 240 93 33

